

**A3D
Clamp Meter**

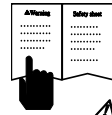

**Instruction
Card**

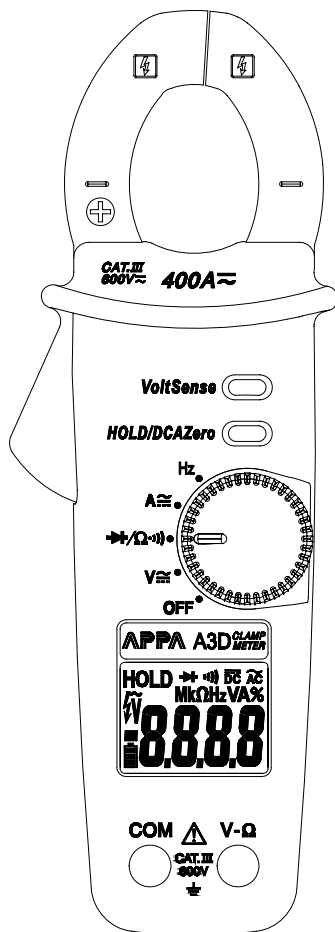

Read First

Safety Information

- To ensure safe operation and service of the Meter, follow these instructions. Failure to observe warnings can result in severe **injury** or **death**.
- Avoid working alone so assistance can be rendered.
 - Do not use test leads or the Clamp Meter if they look damaged.
 - Do not use the Meter if the Clamp Meter is not operating properly or if it is wet.
 - Use the Clamp Meter only as specified in the Instruction card or the protection by the Clamp Meter might be impaired.
 - Individual protective device must be used if hazardous live parts in the installation where the measurement is to be carried out could be accessible.

Symbols as marked on the Tester and Instruction card

	Risk of electric shock
	See instruction card
	Equipment protected by double or reinforced insulation
	Battery
	Earth
	Conforms to EU directives
	Do not discard this product or throw away

Maintenance

Do not attempt to repair this Clamp Meter. It contains no user-serviceable parts. Repair or serving should only be performed by qualified personnel.

Cleaning

Periodically wipe the case with a dry cloth and detergent do not use abrasives or solvents.

Auto Power Off

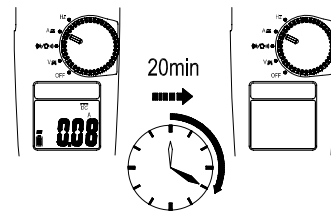

Resistor/Ω I/→

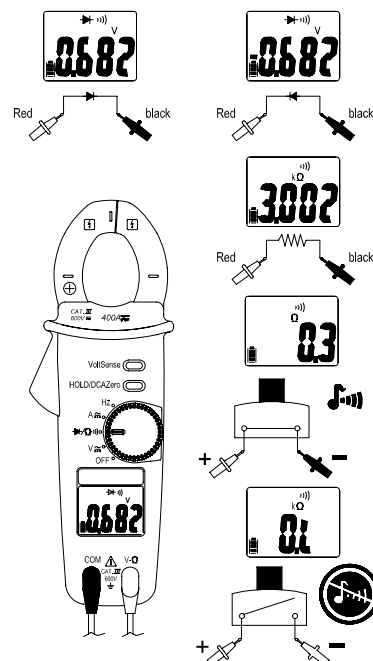

Display Hold

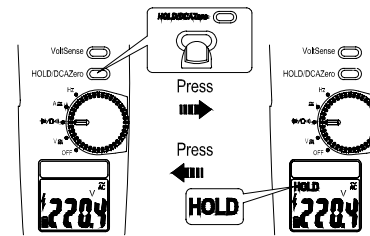

- The internal sounder will operate continuously with LCD display flashing in two situations in the Data Hold mode:
1. The Meter measure a signal different from the LCD reading.
 2. The measured signal is the same unit as the LCD reading and is larger 50 counts than the LCD reading.

AC A / DC A

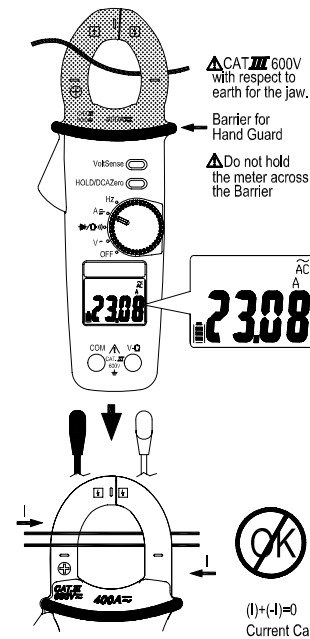

AC V / DC V

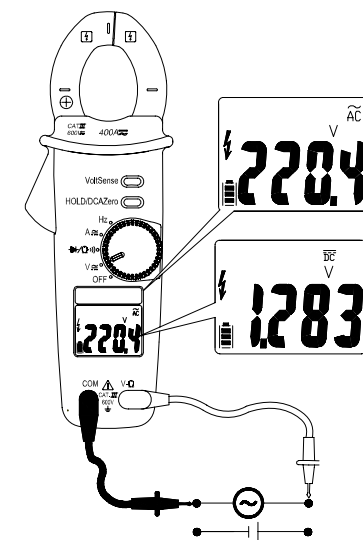

Hz

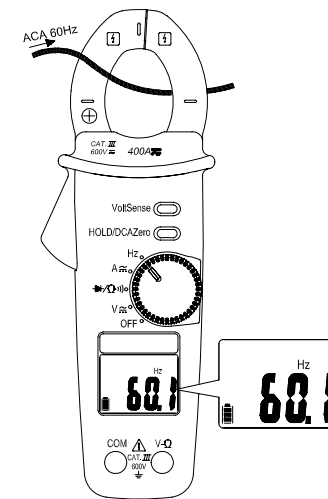

DCA Zero

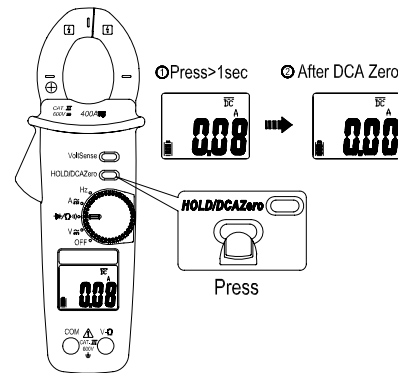

Remove the jaw out of the conductor. Press KEY > 1sec to compensate the residual magnetism.

VoltSense

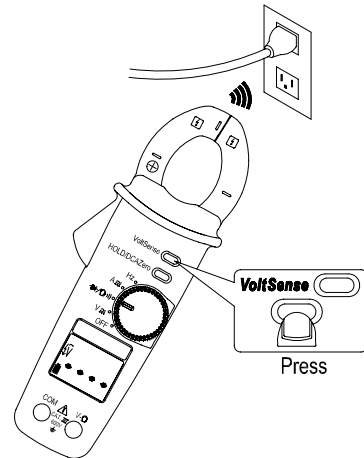

- The number of dashes displaying on the LCD indicates the electric field intensity. If no indication, voltage could still be present.

Battery replacement

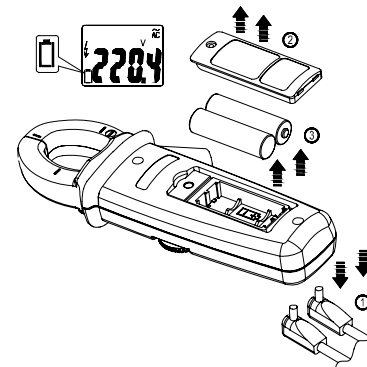

Specifications

1-1 General Specifications

LCD display digits : 4000 counts large scale LCD readout.

Measuring rate : 3 times / sec.

Overrange display :

"OL" is displayed for "Ω" functions, shows the real value for "A" and "V" function.

Automatic power off time :

Approximately 20 minutes after power on.

Low battery indicator :  is displayed.

Power requirement : 1.5V x 2 batteries

Battery life : ALKALINE 200 hours

1-2 Environmental Conditions

Indoor Use.

Calibration :

One year calibration cycle.

Operating temperature :

0°C ~ 30°C (≤80% RH)

30°C ~ 40°C (≤75% RH)

40°C ~ 50°C (≤45%RH)

Storage temperature : -20 to +60°C, 0 to 80% RH (batteries not fitted).

Overvoltage category :

IEC 61010-1 600V CAT. III.

CAT Application field

I	The circuits are not connected to mains.
II	The circuits are directly connected to Low-voltage installation.
III	The building installation.
IV	The source of the Low-voltage installation.

Operating altitude : 2000m (6562 ft)

Conductor Size : 27mm diameter.

Pollution degree : 2

EMC : EN 61326-1

Shock vibration :

Sinusoidal vibration per MIL-T-28800E (5 ~ 55 Hz, 3g maximum).

Drop Protection : 4 feet drop to hardwood on concrete floor.

Dimensions (W x H x D) :

56mm x 188mm x 28mm

Weight : 225g including battery.

Accessories : Battery (installed), Carrying case, Test lead and User manual.

1-3 Electrical Specifications

Accuracy is ±(% reading + number of digits) at 23°C ± 5°C < 80%RH.

Temperature coefficient :

Add 0.2 x (Specified accuracy) / °C, < 18°C, > 28°C .

ACV

Range	Resolution	Accuracy
400.0V	0.1V	± (0.9%+ 5 D)
600V	1V	

Frequency Response : 50 ~ 500Hz

AC Conversion Type :

AC Coupled Average Sensing, RMS Indication.

Input Impedance : 10MΩ, <100pF.

Overload protection : 600V rms.

DCV

Range	Resolution	Accuracy
400.0V	0.1V	± (0.7%+ 5 D)
600V	1V	

Input Impedance : 10MΩ, <100pF.

Overload protection : 600V rms.

Ohm

Range	Resolution	Accuracy
400.0	0.1	± (0.9%+ 5 D)
4.000K	0.001K	
40.00K	0.01K	

Open Circuit Voltage : 0.4V

Overload protection : 600V rms.

CONTINUITY CHECK

Continuity Threshold : Approx. <50Ω

Continuity Indicator :

2.7KHz Tone Buzzer.

Input Protection : 600V rms.

DIODE

Test Current : 500μA (Typical)

Open Circuit Voltage : 1.8V DC (max).

Input Protection : 600V rms.

Hz

Range	Resolution	Accuracy
40.00Hz	0.01Hz	±(0.3%+ 5 D)
400.0Hz	0.1Hz	
4.000KHz	0.001KHz	
40.00KHz	0.01KHz	

Sensitivity : > 4 Ip

Max.Sensitivity : 600A

Sense Source : ACA

Overload protection : 600V rms.

ACA

Range	Resolution	Accuracy
40.00A	0.01A	± (1.5%+ 5 D)
400.0A	0.1A	

Frequency Response : 50 ~ 500Hz

AC Conversion Type : AC Coupled

Average Sensing, RMS Indication.

Overload protection : 600V rms.

DCA

Range	Resolution	Accuracy
40.00A	0.01A	± (1.5%+ 5 D)
400.0A	0.1A	

Overload protection : 600V rms.

Position Error : ±1.0% of reading.

Limited Warranty

This Meter is warranted to the original purchaser against defects in material and workmanship for 1 year from the date of purchase. During this warranty period, manufacturer will, at its option, replace or repair the defective unit, subject to verification of the defect or malfunction.

This warranty does not cover , disposable batteries, or damage from abuse, neglect, accident, unauthorized repair, alteration, contamination, or abnormal conditions of operation or handling.

Any implied warranties arising out of the sale of this product, including but not limited to implied warranties of merchantability and fitness for a particular purpose, are limited to the above. The manufacturer shall not be liable for loss of use of the instrument or other incidental or consequential damages, expenses, or economic loss, or for any claim or claims for such damage, expense or economic loss. Some states or countries laws vary, so the above limitations or exclusions may not apply to you.

APPATECH CORP.

9F, 119-1 Pao-Zong Rd.,
Shin-Tien, Taipei, 23115, Taiwan.
P.O.Box. 12-24 Shin-Tien, Taiwan.
Tel: +886-2-29178820
Fax: +886-2-29170848
E-mail : info@appatech.com
http: //www.appatech.com